



# FIELD DAY 2023 BRIEFING



Kori Rahman WX5KR  
BVARC Vice President

Updated by Jimmy Vance  
June 2023

# What is “Field Day”?





# What is “Field Day”?

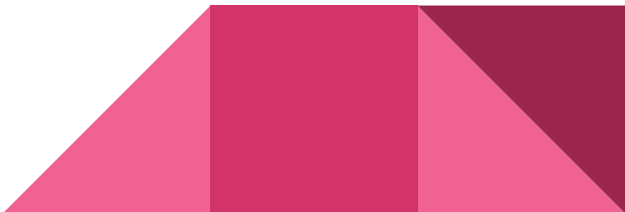

# What is “Field Day”?

- **ARRL Field Day** is the single most popular on-the-air event held annually in the US and Canada. On the fourth weekend of June of each year, thousands of radio amateurs gather with their clubs, groups or simply with friends to operate from remote locations.
  - It is a time where many aspects of Amateur Radio come together to highlight our many roles. While some will treat it as a contest, other groups use the opportunity to practice their emergency response capabilities. It is an excellent opportunity to demonstrate Amateur Radio to the organizations that Amateur Radio might serve in an emergency, as well as the general public. For many clubs, ARRL Field Day is one of the highlights of their annual calendar.
- 



# What is “Field Day”?

- An emergency preparedness drill and practice for field operating
- An educational and public outreach opportunity
- A contest. There are no official winners, but we all want to do well!
- A national day for getting with your ham friends and playing radio
- Field Day is many things to many people. But what it absolutely must be is **FUN!**

# What Takes place at the Multi Club Field Day

- Set up radios for CW (morse code), voice, and digital
- Make great food
- Antenna build class
- Other presentations
- Radio Demos for unlicensed folks and newer hams
- Sleepover for overnight operators
- Raffle off radio gear and other ham stuff
- Satellite contact



# Field Day 2023 a joint venture



# BVARC, KARS, TDXS, UHARC Field Day 2023!

## Where:

Fort Bend County Fire Training Field

260 Clay St.

Richmond, TX 77468





# BVARC, KARS, TDXS, UHARC Field Day 2023!

When: June 23rd - 25th

- Set up on **Friday June 23rd starting at Noon**
- Officially Open to the public Saturday June 24th 9am - 6pm
- Contest hours 1pm Saturday June 24th - 1pm Sunday June 25th
- Clean up and break down **Sunday June 25th 1pm-5pm**



# Technical Aspects and Challenges

- Radios
  - Antennas / Lifts
    - Coax
      - Generators
        - Computers
          - Headsets and keys



# Radios

- Elecraft K3 and K3S



# Antennas

- Beams
  - Tri-Bander 10m-15,-20m
  - 40 meter
- Dipole
  - 80 meter



# Coax

- ½" Heliax is used on the long runs
- LMR-400 is used everywhere else



# Genset / Computers / Headsets

- Generator – Runs radios and logging computers
- Computers – Windows 10, with WiFi. N1MM logging software
- Headsets / Mic - Each station has a headset setup





# Field Day Challenges

- Typical Home station

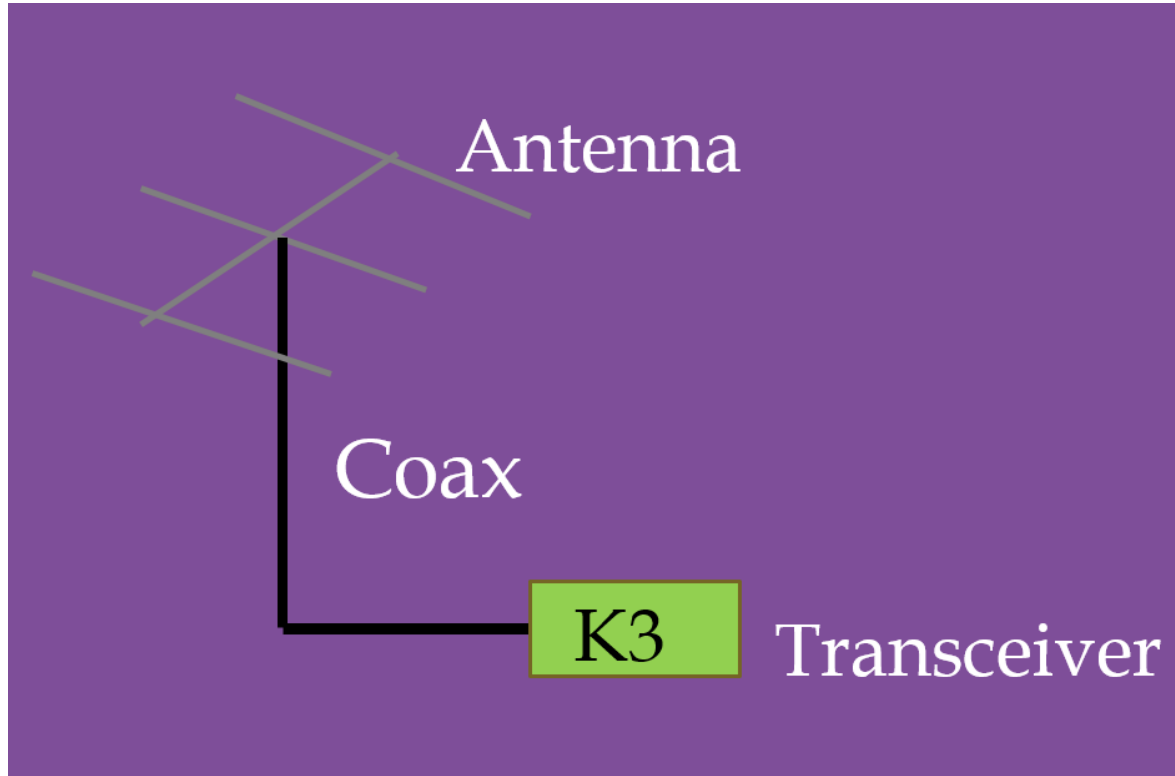

# Field Day Station

All must fit within a  
350' diameter circle

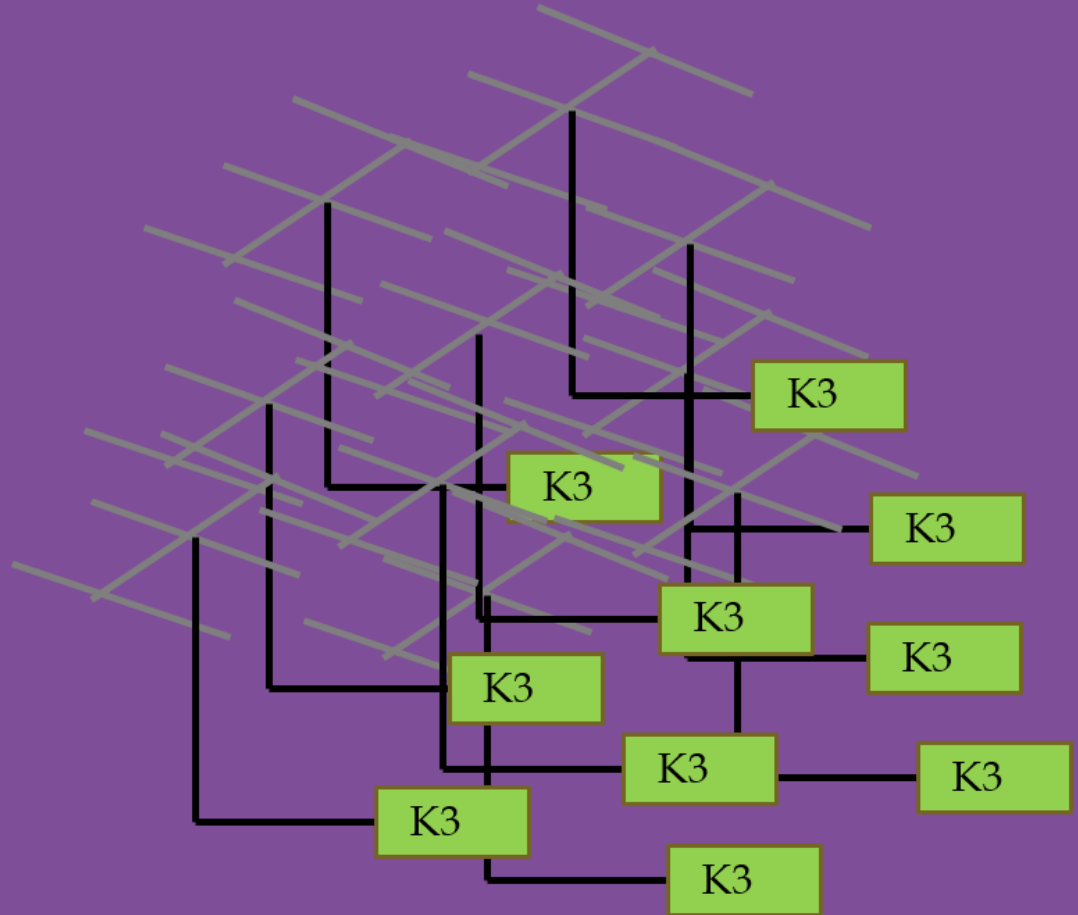

# We have a great geographical location

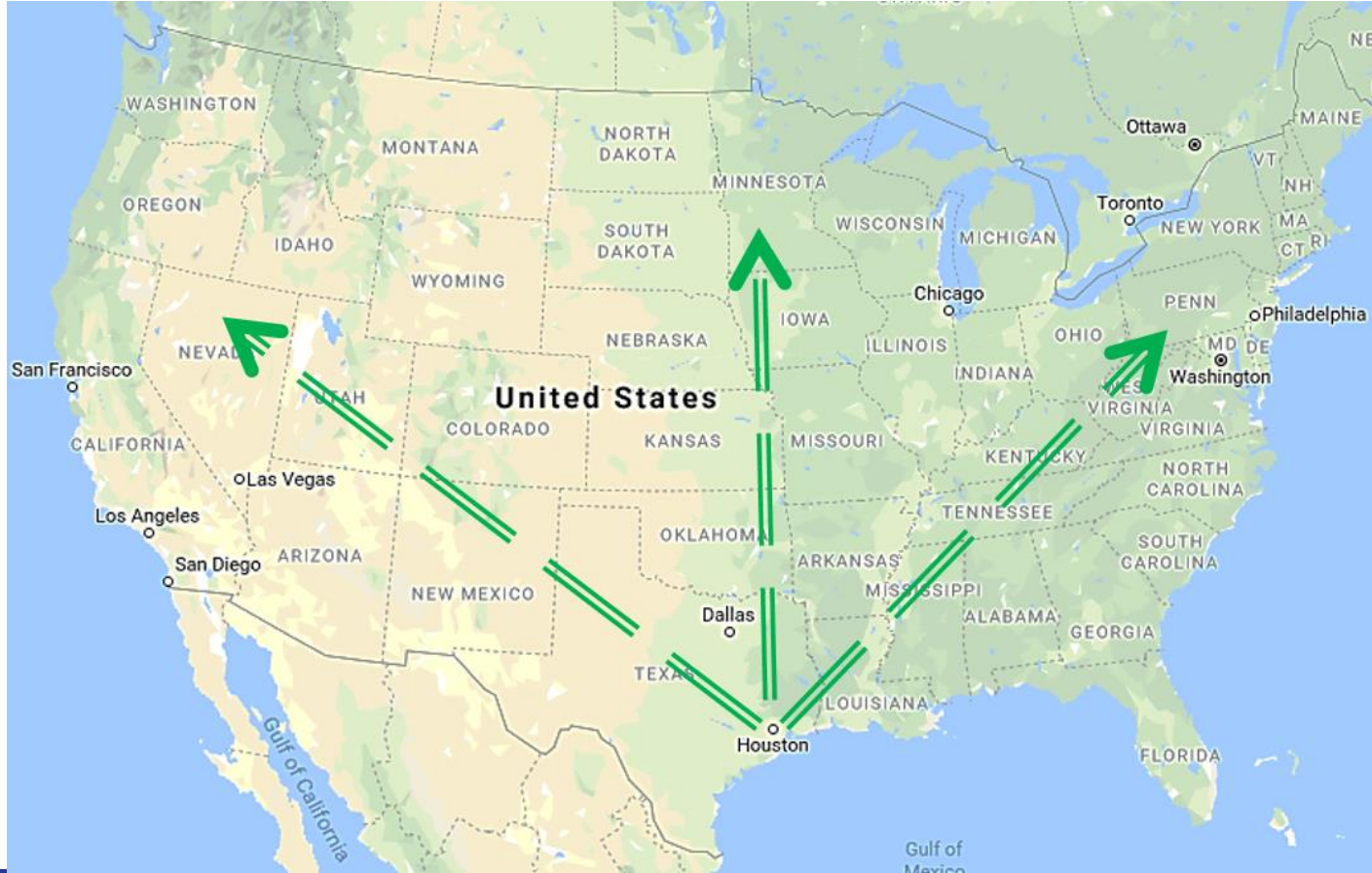

# Yagi-Uda Pattern 40m and Tri-bander

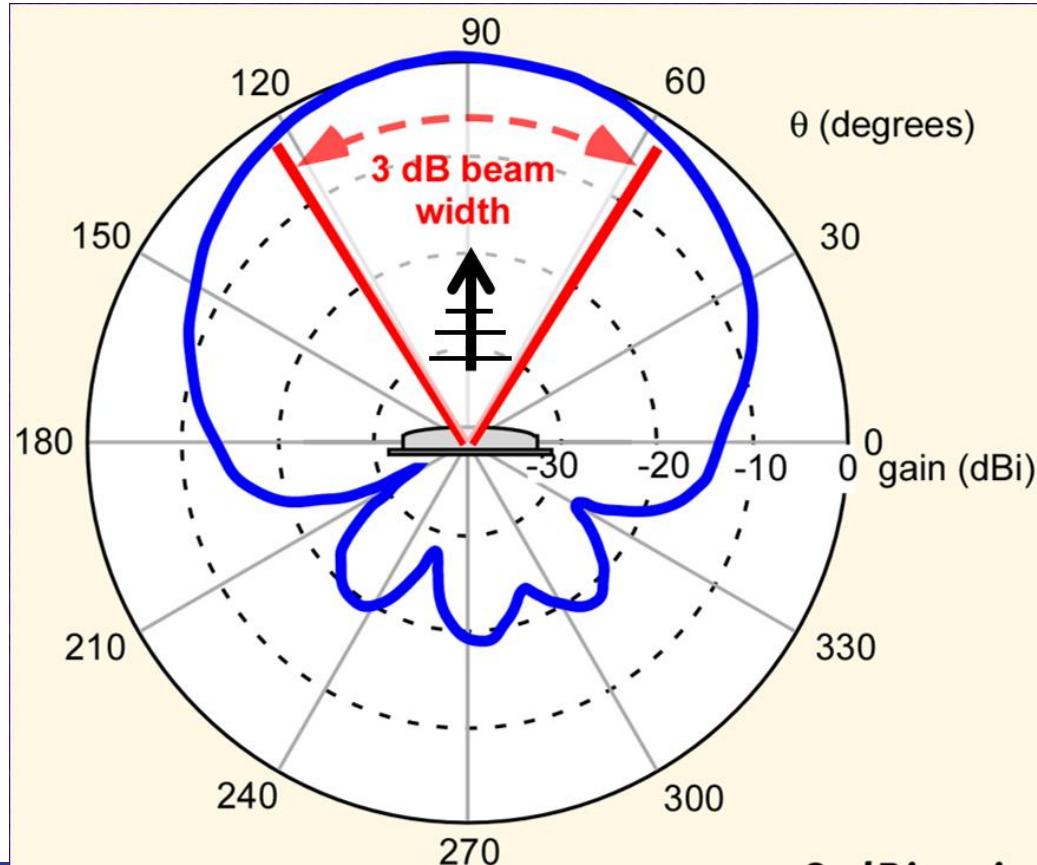

# Where are most of the stations we work?

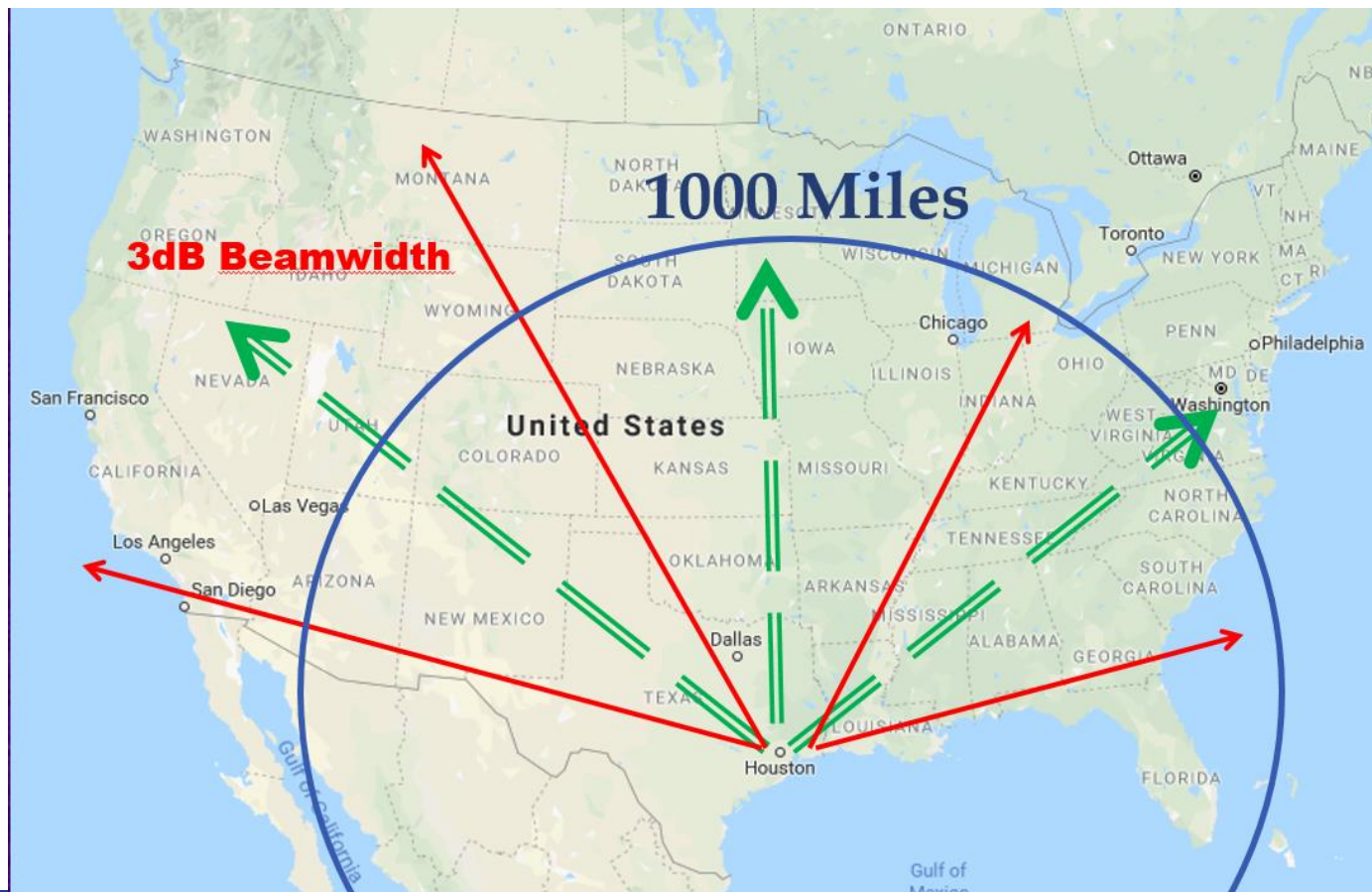

# Tri-Banders and Tri-Plexers

Mosley TA-33 or  
Cushcraft AW3/4

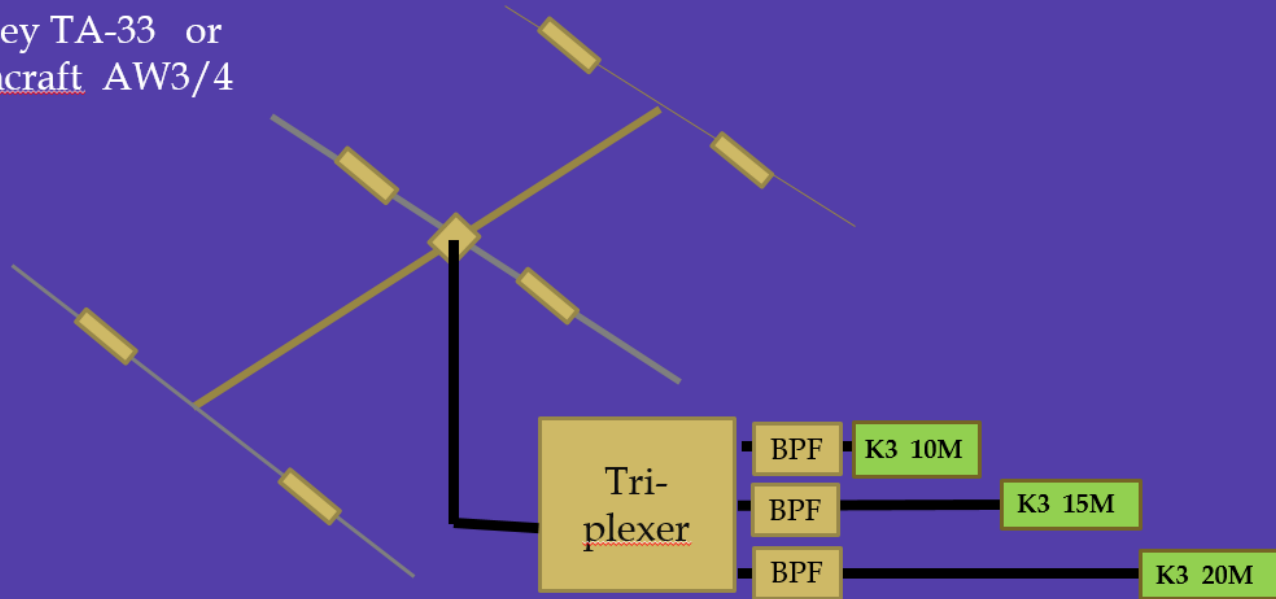

- Splitter on Receive
- Combiner on Transmit



# Triplexer and Band-Pass Filters



# Whats inside the Triplexer?



## What we end up with

Using K3's, Triplexers / Band Pass filters,  
along with critical antenna positioning  
we can create a close spaced, non-  
interfering, 10 transmitter operating  
environment (in 24 hours)

Special thanks to Rick Hiller W5RH for the technical information



# Field Day 2023 Location

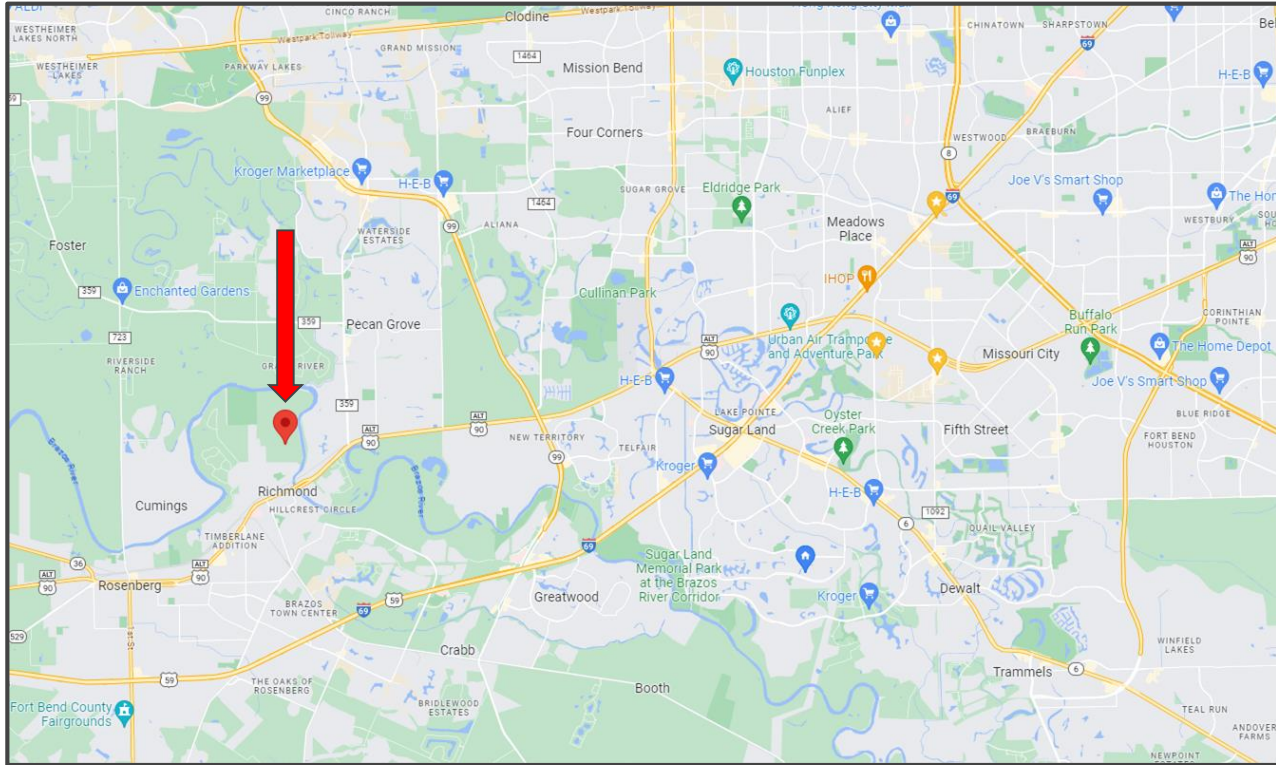



# Field Day 2023 Location

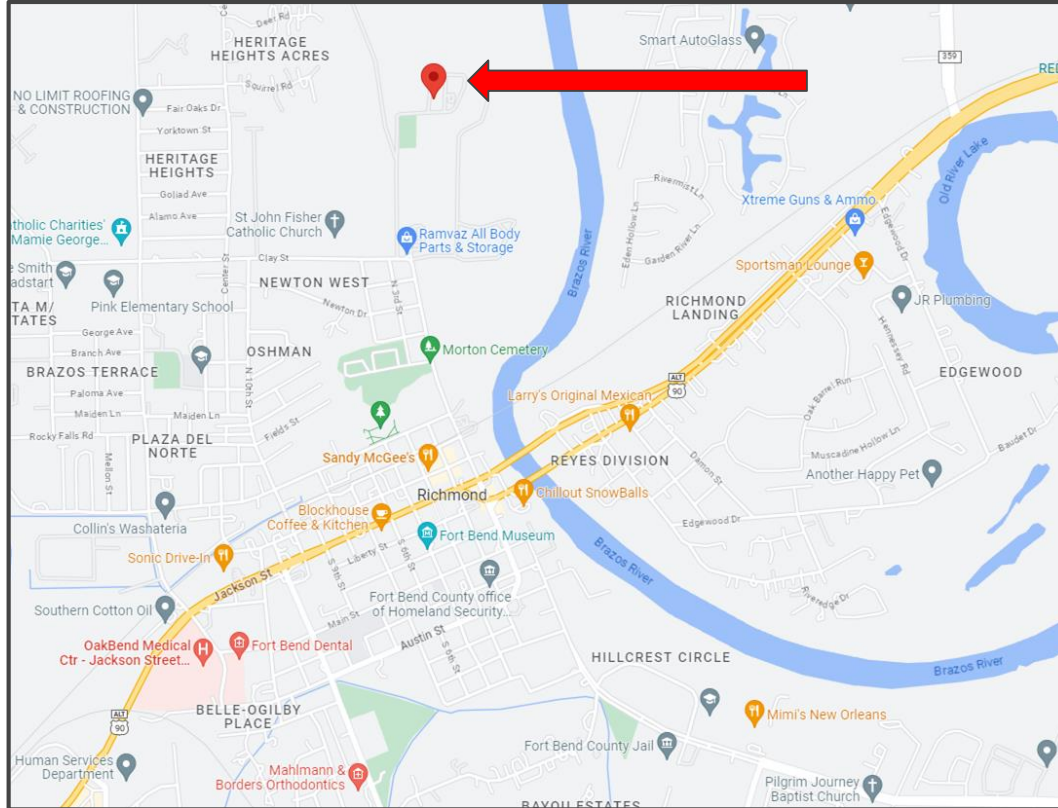

# Field Day 2023 Location

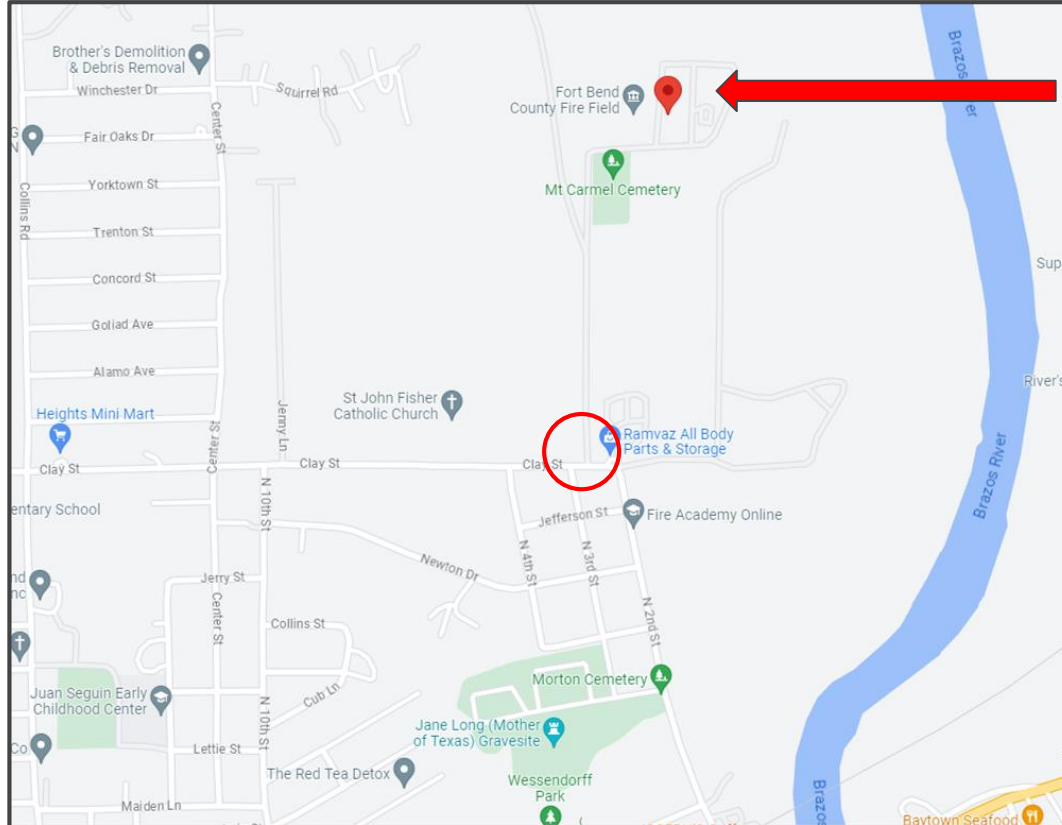



# Field Day 2023 Location



# Field Day 2023 Location



# Field Day 2023 Location





# Field Day 2023 Location





# Field Day 2023 Antenna Layout





# Field Day 2023 Antenna Layout

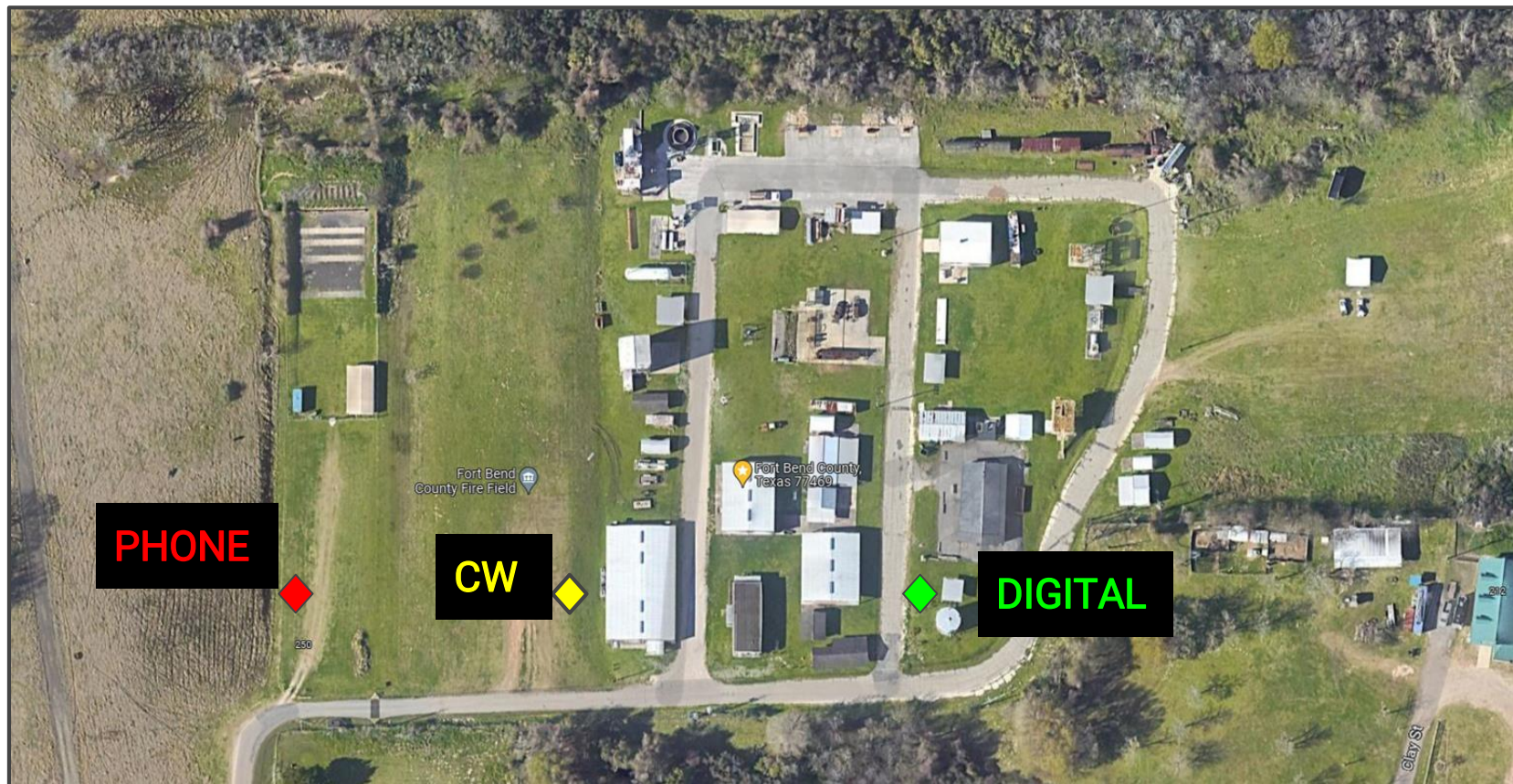



# Field Day 2023 Building Layout

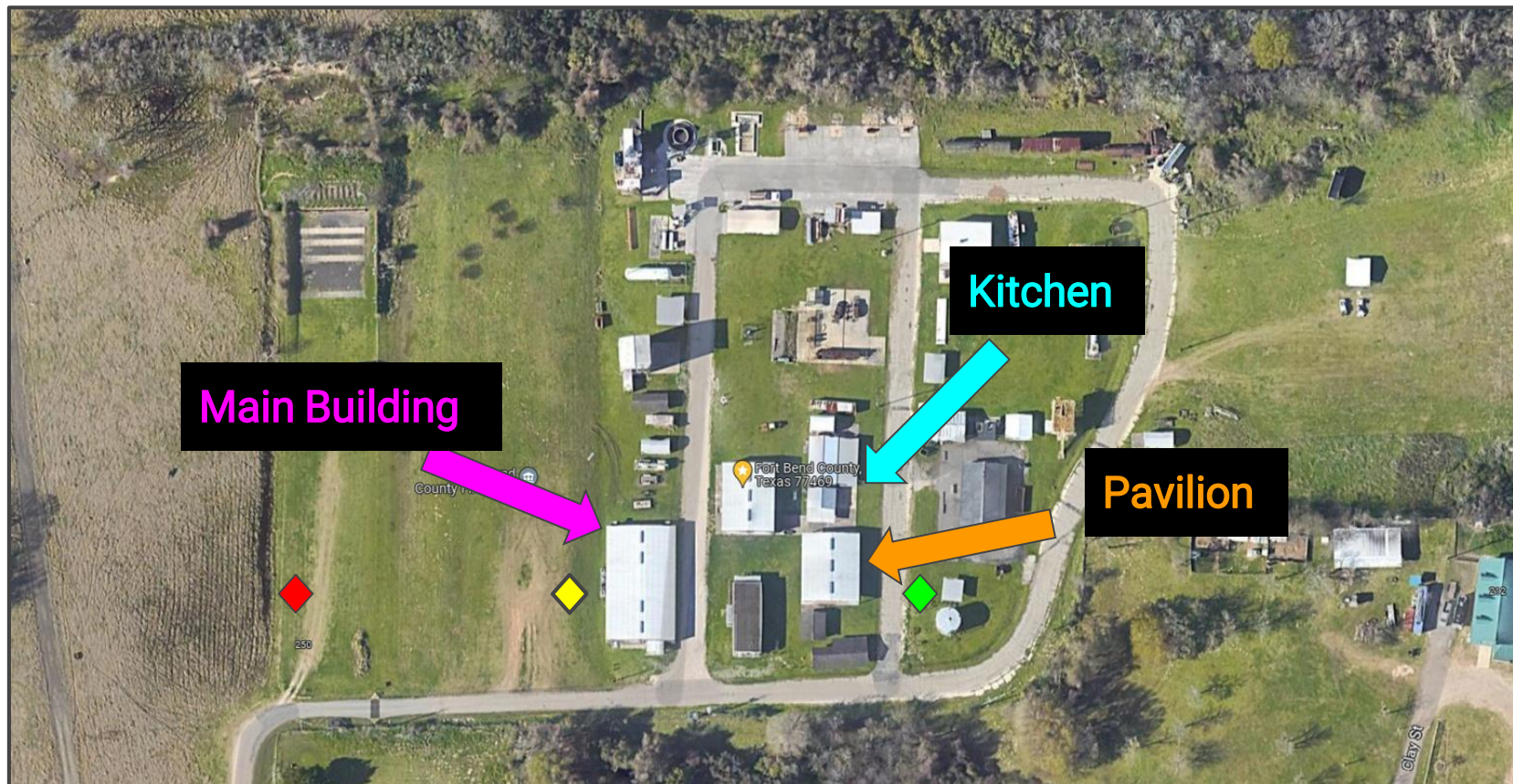



# Field Day 2023 Overall Layout



# Field Day 2023 Overall Layout





# Field Day 2023 Location



# Field Day 2023 Location





# Field Day 2023 Location



# Field Day 2023 Parking Layout

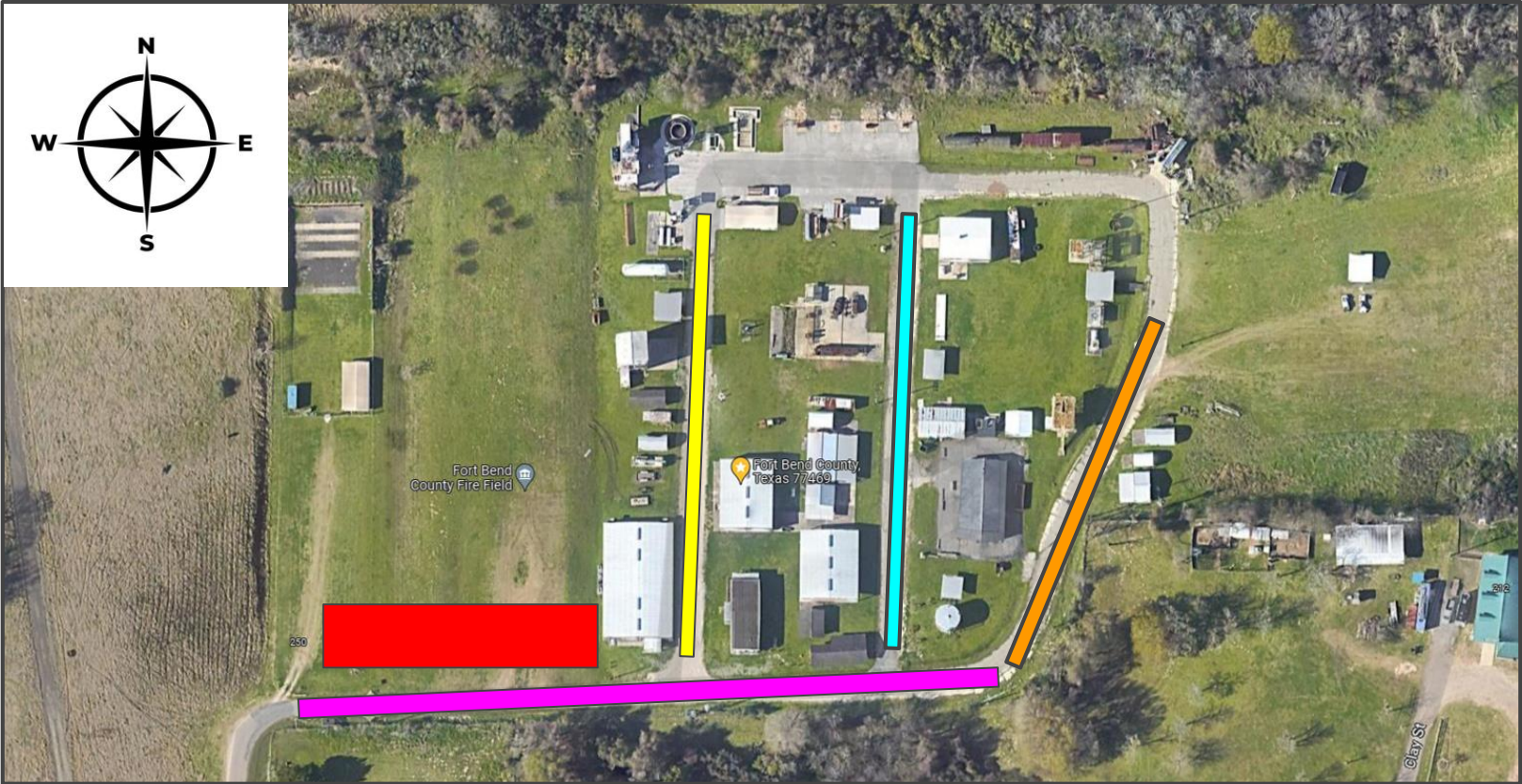



# Main Building Layout

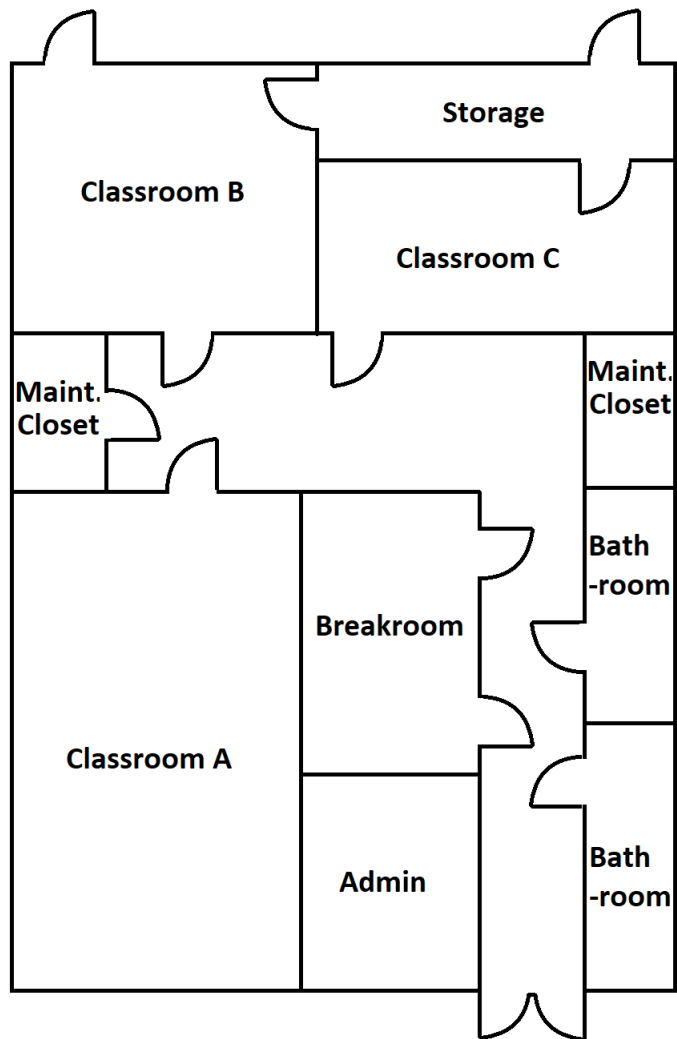

# Building Layout Saturday

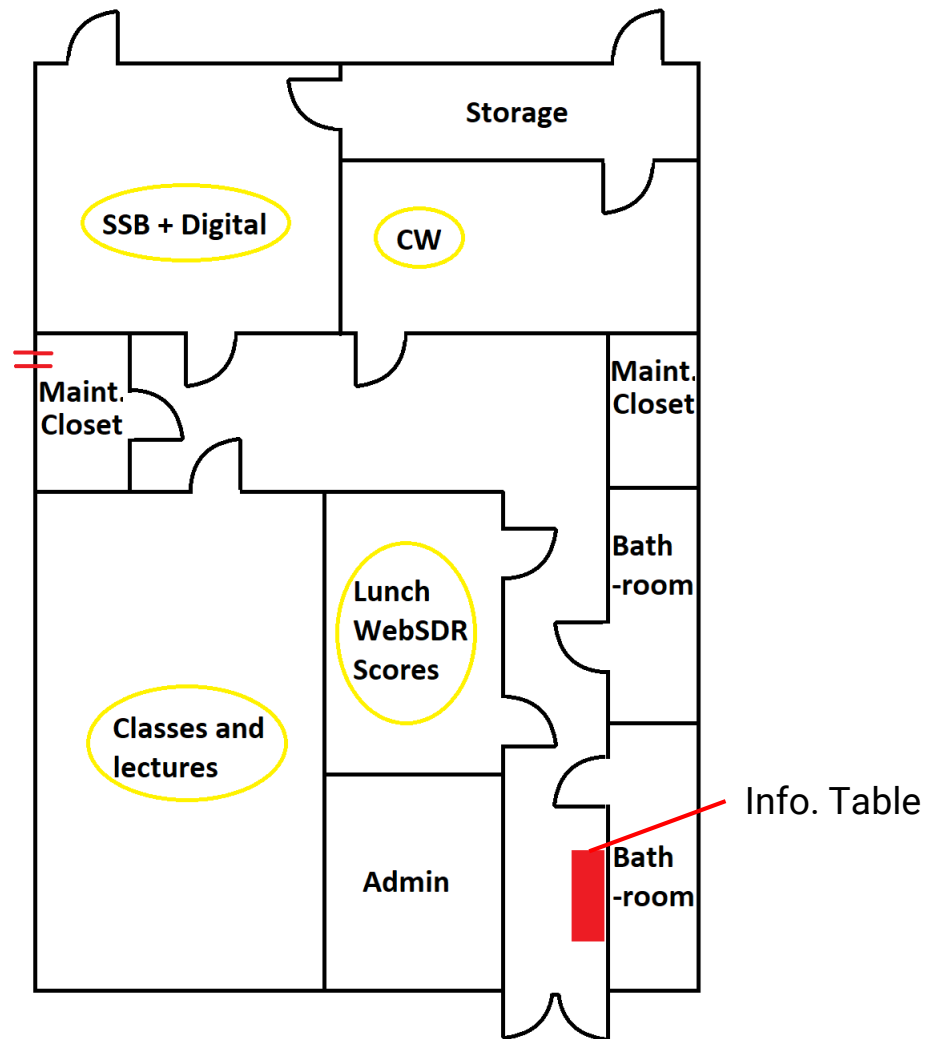

# Building Layout

4pm Saturday -  
Sunday morning

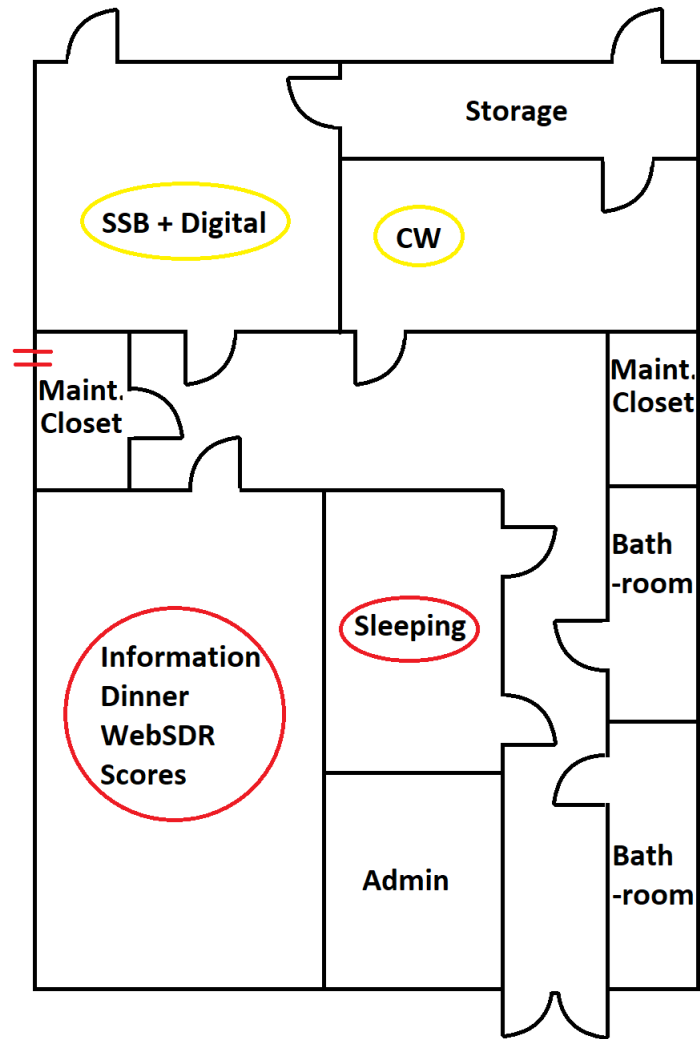

# Field Day 2023 Location



# Field Day 2023 Location





# Field Day 2023 Location





# Field Day 2023 Location



# Field Day Schedule

## Saturday Education (Classroom A):

- 10am-11am Contesting 101 (Dave K5GN)
- 11am-noon DMR Intro (Richard KG5YCU)
- Noon-1pm NTS Traffic (TBD)
- 1pm-2pm 10m Dipole Build Class (Marc KI5ZHO)
- 2pm-4pm EFHW Build Class (Stephen W2WF)

## Contest Operation:

- All SSB, CW, Digital Stations start 1pm Saturday till 1pm Sunday
- Satellite Contact ~5pm-7pm

# Education

## Antenna Build Classes:

- Each class has a limited number of slots (10 for the 10m Dipole, 20 for the EFHW)
- Each class will have some discussion of the antenna being built
- Each student will be provided the materials to build their antenna and tools needed
- Each student will build their antenna in the class and tune it outside afterwards
- Even if the class is full, we encourage you to watch if you are interested
- Sign-up for the classes is here: [Tinyurl.com/FieldDay2023AntennaBuild](https://Tinyurl.com/FieldDay2023AntennaBuild)

# Antenna Class Sign-Up Sheet

## Field Day 2023 Antenna Build Student Sign-up sheet

Please sign up for one slot if you'd like to participate in the class. You will be required to BUILD your antenna in the class and cannot take the materials to build it at home. The instructor will give a brief lecture on the antenna, and the tools and material will be supplied so each student will have an opportunity to build and test their antennas. The class is free but spots are limited (donations are always welcome). Once the class is full this spreadsheet will be locked, however we welcome folks to watch the classes if they'd like. The classes will take place at the BVARC, TDXS, KARS Field Day Event at the FBC Fire Training Field (260 Clay St. Richmond, TX) on Saturday June 24th. Please arrive on time. Once the class time beings, any empty spots will be assigned on a first come basis. After each class is finished building their antennas, they will have an opportunity to tune them outside using a provided antenna analyzer. If you would like to help, please see the volunteer sheet:

[Tinyurl.com/FieldDayVolunteers2023](https://tinyurl.com/FieldDayVolunteers2023)

### 10m Dipole class (1pm - 2pm)

#	Student (Call Sign)
1	K4VMG
2	KD4HNS
3	KI5ZHO
4	KF5UXP
5	KJ5AXC
6	KI5WXW
7	ki5yzg
8	KI5ZMM
9	K6URT
10	KG5YCU

### EFHW class (2pm - 4pm)

#	Student (Call Sign)	#	Call Sign
1	KI5WPE	11	-
2	KI5RLZ	12	-
3	KI6G	13	-
4	KI5ZHO	14	-
5	KF5UXP	15	-
6	KJ5AXC	16	-
7	ki5yzg	17	-
8	KI5ZMM	18	-
9	K6URT	19	-
10	-	20	-



# Contesting

- We will be operating **10A (or more?)**
- There will be 4 CW stations, 4 Voice Stations, and 2 Digital Stations (+?)
- We will be logging with N1MM software (please review if you can)
- Each station will have band plans, ARRL Section lists, how to call CQ, and band labels
- We will have a volunteer role: **Station and Band Coordinator**
- Positions should be selected before Field Day via the sign-up sheet
- Walk-ins are welcome, **but** those who signed up ahead of time will have priority at each station
- The Sign-up sheet can be found here: **[Tiny.cc/2023FieldDay](https://tiny.cc/2023FieldDay)**

# Operator Sign-Up Sheet

## BVARC / TDXS / KARS 2023 MULTI-CLUB FIELD DAY SIGNUP SHEET - KK5W

KK5W / K5DX / KT5TX Fort Bend County Fire Field Richmond, Texas [tiny.cc/2023FieldDay](https://tiny.cc/2023FieldDay)

**Note: All radio quantities are subject to change - slots are not guaranteed**

LOCAL		UTC		CW				LOCAL		UTC		PHONE				LOCAL		UTC		RTTY / FT8 / DATA MODES				CW/PH/DA	GOTA	LOCAL		UTC	
		10	15	20	40	80				10	15	20	40	80					10	15	20	40	80	6	(KT5TX)				
1:00 PM	1800				W5CQN		1:00 PM	1800	K5WLK	N5DTT	KT5XL				1:00 PM	1800	K5WLJ									1:00 PM	1800		
2:00 PM	1900				W5CQN		2:00 PM	1900	K5WLK	N5DTT	KT5XL				2:00 PM	1900	K5WLJ									2:00 PM	1900		
3:00 PM	2000		W5GSH		W5CQN		3:00 PM	2000	K5GYCU	N1ER	AD5Q				3:00 PM	2000				K5SRR						3:00 PM	2000		
4:00 PM	2100				W5CQN		4:00 PM	2100	K5GYCU	N1ER					4:00 PM	2100	K5ZMM			K5SRR						4:00 PM	2100		
5:00 PM	2200		W5GSH		W5CQN		5:00 PM	2200	K5Yzg	N1ER					5:00 PM	2200										5:00 PM	2200		
6:00 PM	2300				K5IZO		6:00 PM	2300		W5LIC	K5RLZ	K5WLJ			6:00 PM	2300										6:00 PM	2300		
7:00 PM	0000				K5IZO		7:00 PM	0000		W5LIC	K5RLZ				7:00 PM	0000										7:00 PM	0000		
8:00 PM	0100				AD5Q		8:00 PM	0100							8:00 PM	0100										8:00 PM	0100		
9:00 PM	0200				AD5Q		9:00 PM	0200							9:00 PM	0200										9:00 PM	0200		
10:00 PM	0300				AD5Q		10:00 PM	0300							10:00 PM	0300										10:00 PM	0300		
11:00 PM	0400				AD5Q		11:00 PM	0400							11:00 PM	0400										11:00 PM	0400		
12:00 AM	0500					AD5Q	12:00 AM	0500							12:00 AM	0500										12:00 AM	0500		
1:00 AM	0600				AD5Q	K5IZO	1:00 AM	0600							1:00 AM	0600										1:00 AM	0600		
2:00 AM	0700				AD5Q	K5IZO	2:00 AM	0700							2:00 AM	0700										2:00 AM	0700		
3:00 AM	0800				AD5Q		3:00 AM	0800							3:00 AM	0800										3:00 AM	0800		
4:00 AM	0900				AD5Q		4:00 AM	0900							4:00 AM	0900										4:00 AM	0900		
5:00 AM	1000					AD5Q	5:00 AM	1000							5:00 AM	1000										5:00 AM	1000		
6:00 AM	1100				AD5Q		6:00 AM	1100							6:00 AM	1100										6:00 AM	1100		
7:00 AM	1200						7:00 AM	1200							7:00 AM	1200										7:00 AM	1200		
8:00 AM	1300						8:00 AM	1300							8:00 AM	1300										8:00 AM	1300		
9:00 AM	1400						9:00 AM	1400				K5RLZ			9:00 AM	1400										9:00 AM	1400		
10:00 AM	1500						10:00 AM	1500				W5LIC			10:00 AM	1500										10:00 AM	1500		
11:00 AM	1600						11:00 AM	1600							11:00 AM	1600										11:00 AM	1600		
12:00 PM	1700						12:00 PM	1700							12:00 PM	1700										12:00 PM	1700		

Any questions or issues, please contact Allen N5XZ at n5xz@arrl.net / 713-705-4801 or Kori Rahman at kori113@gmail.com

Note: Slots with call signs in RED are provisional based on dx availability and band conditions



# US Amateur Radio Bands

## US AMATEUR POWER LIMITS

FCC 97.313 An amateur station must use the minimum transmitter power necessary to carry out the desired communications.  
(b) No station may transmit with a transmitter power exceeding 1.5 kW PEP.

Amateurs wishing to operate on either 2.200 or 630 meters must first register with the Utilities Technology Council online at <https://utc.org/plc-database-amateur-notification-process/>. You need only register once for each band.

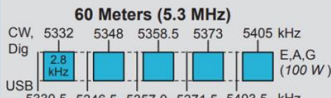
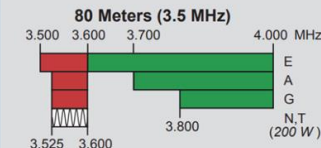
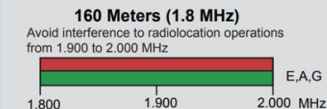
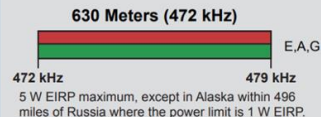
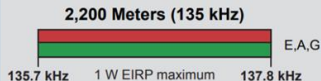

General, Advanced, and Amateur Extra licensees may operate on these five channels on a secondary basis with a maximum effective radiated power (ERP) of 100 W PEP relative to a half-wave dipole. Permitted operating modes include upper sideband voice (USB), CW, RTTY, PSK31 and other digital modes such as PACTOR III. Only one signal at a time is permitted on any channel.

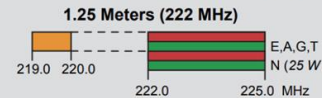
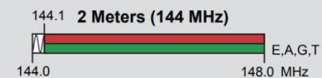
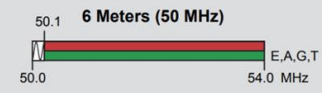
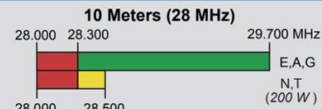
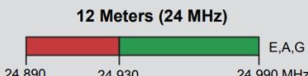
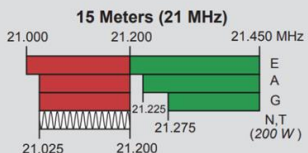
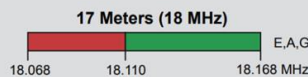
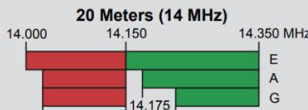
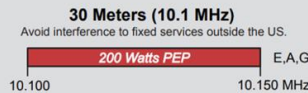
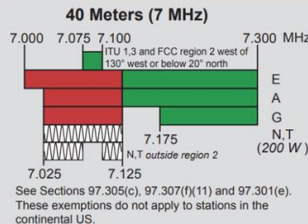

\*Geographical and power restrictions may apply to all bands above 420 MHz. See *The ARRL Operating Manual* for information about your area.

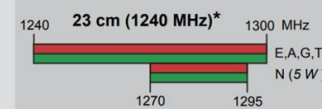
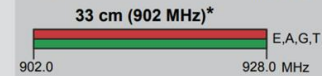

All licensees except Novices are authorized all modes on the following frequencies:

2300-2310 MHz	10.0-10.5 GHz ‡	122.25-123.0 GHz
2390-2450 MHz	24.0-24.25 GHz	134-141 GHz
3300-3500 MHz	47.0-47.2 GHz	241-250 GHz
5650-5850 MHz	76.0-81.0 GHz	All above 275 GHz

‡ No pulse emissions



**ARRL** The national association for AMATEUR RADIO®

## KEY

**Note:**  
CW operation is permitted throughout all amateur bands.

MCW is authorized above 50.1 MHz, except for 144.0-144.1 and 219-220 MHz. Test transmissions are authorized above 51 MHz, except for 219-220 MHz

- █ = RTTY and data
- █ = phone and image
- █ = CW only
- █ = SSB phone
- █ = USB phone, CW, RTTY, and data
- █ = Fixed digital message forwarding systems only

E = Amateur Extra  
A = Advanced  
G = General  
T = Technician  
N = Novice

See *ARRLWeb* at [www.arrl.org](http://www.arrl.org) for detailed band plans.

**ARRL**  
**We're At Your Service**

ARRL Headquarters:  
860-594-0200 (Fax 860-594-0259)  
email: [hq@arrl.org](mailto:hq@arrl.org)

Publication Orders:  
[www.arrl.org/shop](http://www.arrl.org/shop)  
Toll-Free 1-888-277-5289 (860-594-0355)  
email: [orders@arrl.org](mailto:orders@arrl.org)

Membership/Circulation Desk:  
[www.arrl.org/membership](http://www.arrl.org/membership)  
Toll-Free 1-888-277-5289 (860-594-0338)  
email: [membership@arrl.org](mailto:membership@arrl.org)

Getting Started in Amateur Radio:  
Toll-Free 1-800-326-3942 (860-594-0355)  
email: [newham@arrl.org](mailto:newham@arrl.org)

Exams: 860-594-0300 email: [vec@arrl.org](mailto:vec@arrl.org)



ARRLWASmap02

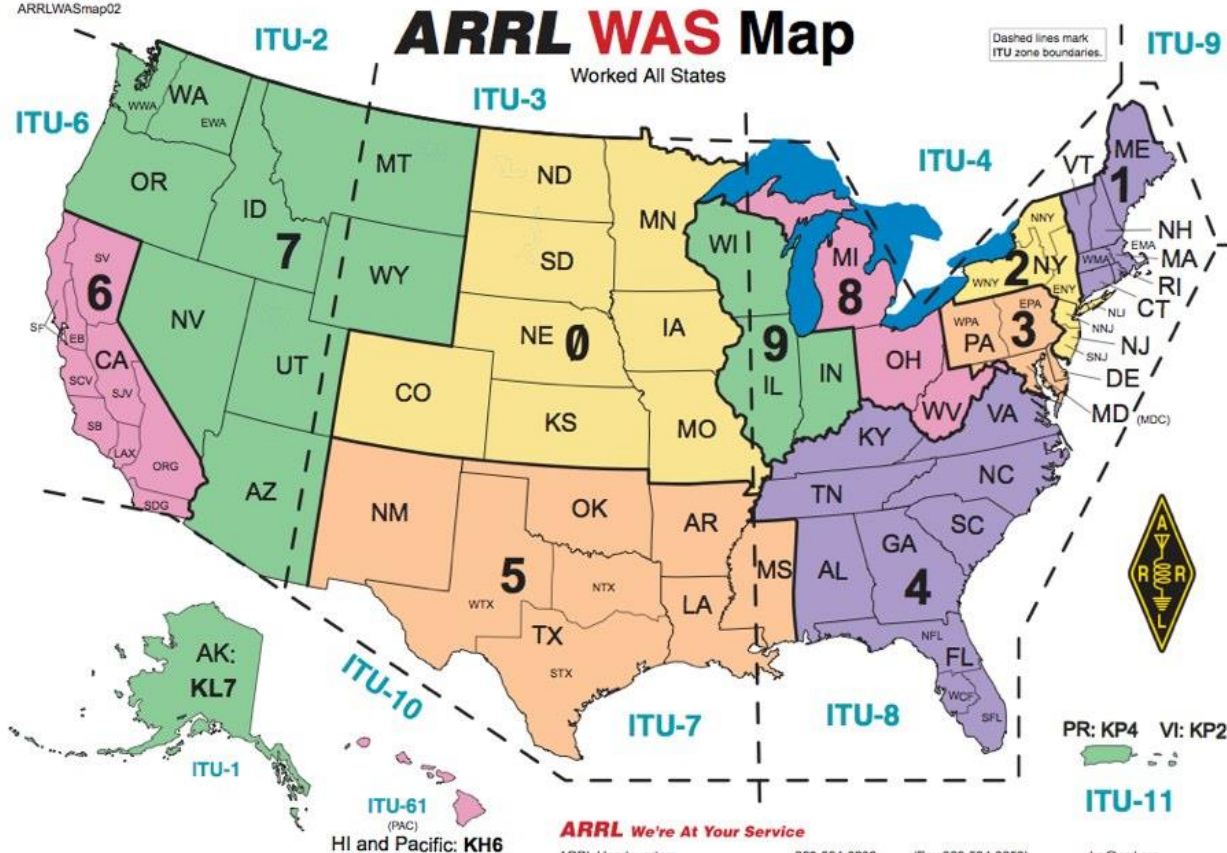

**ARRL** The national association for  
**AMATEUR RADIO**

Copyright © 2005 by the American Radio Relay League, Inc. All Rights Reserved. rev 11-09

### ARRL We're At Your Service

ARRL Headquarters  
Publication Orders  
Membership/Circulation Desk  
Getting Started in Amateur Radio  
Exams  
ARRL on the World Wide Web

860-594-0200 (Fax 860-594-0259)  
Toll-Free 1-888-277-5289 (860-594-0355)  
Toll-Free 1-888-277-5289 (860-594-0338)  
Toll-Free 1-800-326-3942 (860-594-0355)  
860-594-0300  
www.arrl.org/

hq@arrl.org  
orders@arrl.org  
membership@arrl.org  
newham@arrl.org  
vec@arrl.org

## ARRL / RAC Section Abbreviation List

**1**

Connecticut	CT	Rhode Island	RI
Eastern Massachusetts	EMA	Vermont	VT
Maine	ME	Western Massachusetts	WMA
New Hampshire	NH		

**2**

Eastern New York	ENY	Northern New York	NNY
NYC / Long Island	NLI	Southern New Jersey	SNJ
Northern New Jersey	NNJ	Western New York	WNY

**3**

Delaware	DE	Maryland – DC	MDC
Eastern Pennsylvania	EPA	Western Pennsylvania	WPA

**4**

Alabama	AL	Southern Florida	SFL
Georgia	GA	Tennessee	TN
Kentucky	KY	Virginia	VA
North Carolina	NC	West Central Florida	WCF
Northern Florida	NFL	Puerto Rico	PR
South Carolina	SC	US Virgin Islands	VI

**5**

Arkansas	AR	North Texas	NTX
Louisiana	LA	Oklahoma	OK
Mississippi	MS	South Texas	STX
New Mexico	NM	West Texas	WTX

**6**

East Bay	EB	San Diego	SDG
Los Angeles	LAX	San Francisco	SF
Orange	ORG	San Joaquin Valley	SJV
Santa Barbara	SB	Sacramento Valley	SV
Santa Clara Valley	SCV	Pacific	PAC

**7**

Alaska	AK	Nevada	NV
--------	----	--------	----



This station is for operating on the

# 20m

band ONLY

**DO NOT CHANGE THE BAND**

**Changing bands WILL damage the radio!**

The 20m band plan is below, please use the appropriate frequency range for the mode you are using:

Voice (Upper Sideband/USB): 14.150MHz – 14.350MHz

Data: 14.000MHz – 14.150MHz

FT8: 14.074MHz USB

**Club Calls Sign:**

# KK5W

**Our Class: 10A**

**Our Section: STX (South Texas)**

**Calling CQ:**

"CQ Field Day CQ Field Day this is KK5W Calling CQ CQ Field Day..."

Stand by for a station to come back, for example if K0ABC comes back you respond:

"K0ABC this is KK5W Please copy 10A South Texas STX"

Copy their call sign, class, and section into your log and save it.  
Use the NATO phonetics (right of page) as much as possible.

That's the basics, have fun!

A	Alpha
B	Bravo
C	Charlie
D	Delta
E	Echo
F	Foxtrot
G	Golf
H	Hotel
I	India
J	Juliett
K	Kilo
L	Lima
M	Mike
N	November
O	Oscar
P	Papa
Q	Quebec
R	Romeo
S	Sierra
T	Tango
U	Uniform
V	Victor
W	Whiskey
X	X-ray
Y	Yankee
Z	Zulu



# Volunteers needed

## Friday:

- **Antenna Crew (3)**
  - Report to Bill W5VOM
  - Will help assemble and deploy the antennas, masts, and run coax
- **Radio Crew (3)**
  - Report to Allen N5XZ or Jimmy NA5D
  - Will help install filters, radios, power supplies etc.
- **Computer Crew (3)**
  - Report to Glenn WB5TUF
  - Will help connect up CPUs, monitors, keyboard etc. and make connections to radios
- Volunteer Sign-up here: [Tinyurl.com/FieldDayVolunteers2023](https://Tinyurl.com/FieldDayVolunteers2023)

# Volunteers needed

## Saturday:

- **Station and Band Coordinator (1 hour slots for 24 hours)**
  - Will guard the SSB+Digital room and keep noise down, distractions to a minimum and will make sure operators are following the sign up sheet
- **Antenna Class help (1 hour slots for 4 hours)**
  - Will assist antenna build class teachers with set up and clean up
- **Talk-in Net Control (1 hour slots for 9 hours)**
  - Periodically announce the net and event
  - Monitor the 146.940 MHz repeater and take any traffic (coordinating with volunteers off-site, give directions etc.)
- Volunteer Sign-up here: [Tinyurl.com/FieldDayVolunteers2023](https://Tinyurl.com/FieldDayVolunteers2023)

# Volunteers needed

## Saturday and Sunday

- **Information Table (Saturday 5 slots, 1 hour each for 9 hours)**
  - Will stand at the information table area and greet those who come in
  - Make sure everyone signs in
  - Show newcomers amateur radio, explain what Field Day is
  - Provide handouts and promotional material
  - Direct folks to the appropriate rooms if they are signed up to operate
  - Demonstrate the WebSDR station
  - General Help
- Volunteer Sign-up here: [Tinyurl.com/FieldDayVolunteers2023](https://Tinyurl.com/FieldDayVolunteers2023)



# Volunteers needed

## Saturday and Sunday

- **General help (2 slots, 1 hour each for 20 hours)**
  - Will be there to keep an eye on the facility and provide general help as needed
- **Sunday Break Down Crew (6 slots, 3 hour each)**
  - Essential team to help disassemble and move out equipment
  - Clean up rooms
  - Restore rooms back to the way they were Friday
- Volunteer Sign-up here: [Tinyurl.com/FieldDayVolunteers2023](https://tinyurl.com/FieldDayVolunteers2023)

# Volunteer Sign-Up Sheet

BVARC, TDXS, KARS ARRL Field Day 2023 Volunteer Sign-up sheet						Volunteer Frequency Plan																																																																												
<p>There are MANY MANY important volunteer roles we need filled. Please see the list below with detailed descriptions (scroll down to see all). Type in your call sign (or name if you do not have a call sign) in the spaces open. Please do not sign up for more than three consecutive hours. Most of the positions will be easygoing, but we also want you to take some time enjoy the various activities going on at Field Day AND operate the stations! Meals will be brought to you if you at your assigned location during meal times. If you sign up but are unable to come, please let us know as soon as possible. If you sign up please attend some of the Field Day planning meetings this month. If you have any questions or recommendations about further volunteer positions please contact Kori Rahman WX5KR at Kori113@gmail.com</p>						<p>General Volunteer FM Simplex: 147.550 MHz</p> <p>Crossband repeat (to the 146.940MHz Repeater) 446.4375MHz PL 103.5 Hz</p> <p>Leads Direct FM Simplex: 446.125MHz</p> <p>Please program these into your HTs before the event.</p>																																																																												
<p><b>Saturday Information Table, SDR, Info. Screens, and General Help</b></p> <table border="1"> <thead> <tr> <th>Time:</th> <th>Volunteer 1</th> <th>Volunteer 2</th> <th>Volunteer 3</th> <th>Volunteer 4</th> <th>Volunteer 5</th> </tr> </thead> <tbody> <tr><td>9am - 10am</td><td>-</td><td>-</td><td>-</td><td>-</td><td>-</td></tr> <tr><td>10am - 11am</td><td>KF5UXP</td><td>-</td><td>-</td><td>-</td><td>-</td></tr> <tr><td>11am - Noon</td><td>-</td><td>-</td><td>-</td><td>-</td><td>-</td></tr> <tr><td>Noon - 1pm</td><td>-</td><td>-</td><td>-</td><td>-</td><td>-</td></tr> <tr><td>1pm - 2pm</td><td>-</td><td>-</td><td>-</td><td>-</td><td>-</td></tr> <tr><td>2pm - 3pm</td><td>-</td><td>-</td><td>-</td><td>-</td><td>-</td></tr> <tr><td>3pm - 4pm</td><td>KI5WXX</td><td>-</td><td>-</td><td>-</td><td>-</td></tr> <tr><td>4pm - 5pm</td><td>KI5WXX</td><td>-</td><td>-</td><td>-</td><td>-</td></tr> <tr><td>5pm - 6pm</td><td>KI5WXX</td><td>-</td><td>-</td><td>-</td><td>-</td></tr> </tbody> </table>						Time:	Volunteer 1	Volunteer 2	Volunteer 3	Volunteer 4	Volunteer 5	9am - 10am	-	-	-	-	-	10am - 11am	KF5UXP	-	-	-	-	11am - Noon	-	-	-	-	-	Noon - 1pm	-	-	-	-	-	1pm - 2pm	-	-	-	-	-	2pm - 3pm	-	-	-	-	-	3pm - 4pm	KI5WXX	-	-	-	-	4pm - 5pm	KI5WXX	-	-	-	-	5pm - 6pm	KI5WXX	-	-	-	-	<p>Saturday Information Table helpers will be responsible for meeting guests as they come in and getting them signed in and where they need to be. Please fill in the "Volunteer 1" position first, we would like at least a couple of slots filled per hour, but we will take up to 5 per hour if we can get them. There will be flyers to hand out, a computer running a WebSDR station you can show our guests, and the sign-up sheet will be posted on a screen which you will use to direct folks to their stations or add newcomers to the list as they come in. We need lots of folks to take care of this position as we anticipate a large number of the general public and new hams to attend.</p>																
Time:	Volunteer 1	Volunteer 2	Volunteer 3	Volunteer 4	Volunteer 5																																																																													
9am - 10am	-	-	-	-	-																																																																													
10am - 11am	KF5UXP	-	-	-	-																																																																													
11am - Noon	-	-	-	-	-																																																																													
Noon - 1pm	-	-	-	-	-																																																																													
1pm - 2pm	-	-	-	-	-																																																																													
2pm - 3pm	-	-	-	-	-																																																																													
3pm - 4pm	KI5WXX	-	-	-	-																																																																													
4pm - 5pm	KI5WXX	-	-	-	-																																																																													
5pm - 6pm	KI5WXX	-	-	-	-																																																																													
<p><b>Saturday Antenna Classes Help</b></p> <table border="1"> <thead> <tr> <th>Time:</th> <th>Volunteer 1</th> <th>Volunteer 2</th> </tr> </thead> <tbody> <tr><td>Noon - 1pm</td><td>KF5UXP Chuck Hale</td><td>-</td></tr> <tr><td>1pm - 2pm</td><td>AI5KD - Bubba Flowers</td><td>-</td></tr> <tr><td>2pm - 3pm</td><td>-</td><td>-</td></tr> <tr><td>3pm - 4pm</td><td>-</td><td>-</td></tr> </tbody> </table>						Time:	Volunteer 1	Volunteer 2	Noon - 1pm	KF5UXP Chuck Hale	-	1pm - 2pm	AI5KD - Bubba Flowers	-	2pm - 3pm	-	-	3pm - 4pm	-	-	<p>Antenna class helpers will help the instructors set out the materials for the class, help clean up after the class, and generally help the instructor as needed. The current schedule for the antenna build classes are 1pm - 2pm for the 10m dipole build by Marc KI5ZHO, and the EFHW class will be from 2pm - 4pm by Stephen W2WV. Tuning of the antennas will be done outside after each class is done building.</p>																																																													
Time:	Volunteer 1	Volunteer 2																																																																																
Noon - 1pm	KF5UXP Chuck Hale	-																																																																																
1pm - 2pm	AI5KD - Bubba Flowers	-																																																																																
2pm - 3pm	-	-																																																																																
3pm - 4pm	-	-																																																																																
<p><b>Station and Band Coordinator</b></p> <table border="1"> <thead> <tr> <th>Time:</th> <th>Volunteer 1</th> <th>Volunteer 2</th> </tr> </thead> <tbody> <tr><td>Saturday:</td><td>-</td><td>-</td></tr> <tr><td>1pm - 2pm</td><td>K5GN Dave McCarty (SSB)</td><td>-</td></tr> <tr><td>2pm - 3pm</td><td>-</td><td>-</td></tr> <tr><td>3pm - 4pm</td><td>-</td><td>-</td></tr> <tr><td>4pm - 5pm</td><td>K5Yzq version [ssb] dmr.gpms</td><td>-</td></tr> <tr><td>5pm - 6pm</td><td>-</td><td>-</td></tr> <tr><td>6pm - 7pm</td><td>-</td><td>-</td></tr> <tr><td>7pm - 8pm</td><td>-</td><td>-</td></tr> <tr><td>8pm - 9pm</td><td>-</td><td>-</td></tr> <tr><td>9pm - 10pm</td><td>-</td><td>-</td></tr> <tr><td>10pm - 11pm</td><td>-</td><td>-</td></tr> <tr><td>11pm - 12am</td><td>-</td><td>-</td></tr> <tr><td>Sunday:</td><td>-</td><td>-</td></tr> <tr><td>12am - 1am</td><td>K5GN Dave McCarty (SSB)</td><td>-</td></tr> <tr><td>1am - 2am</td><td>-</td><td>-</td></tr> <tr><td>2am - 3am</td><td>-</td><td>-</td></tr> <tr><td>3am - 4am</td><td>-</td><td>-</td></tr> <tr><td>4am - 5am</td><td>-</td><td>-</td></tr> <tr><td>5am - 6am</td><td>-</td><td>-</td></tr> <tr><td>6am - 7am</td><td>-</td><td>-</td></tr> <tr><td>7am - 8am</td><td>-</td><td>-</td></tr> <tr><td>8am - 9am</td><td>-</td><td>-</td></tr> <tr><td>9am - 10am</td><td>-</td><td>-</td></tr> <tr><td>10am - 11am</td><td>-</td><td>-</td></tr> </tbody> </table>						Time:	Volunteer 1	Volunteer 2	Saturday:	-	-	1pm - 2pm	K5GN Dave McCarty (SSB)	-	2pm - 3pm	-	-	3pm - 4pm	-	-	4pm - 5pm	K5Yzq version [ssb] dmr.gpms	-	5pm - 6pm	-	-	6pm - 7pm	-	-	7pm - 8pm	-	-	8pm - 9pm	-	-	9pm - 10pm	-	-	10pm - 11pm	-	-	11pm - 12am	-	-	Sunday:	-	-	12am - 1am	K5GN Dave McCarty (SSB)	-	1am - 2am	-	-	2am - 3am	-	-	3am - 4am	-	-	4am - 5am	-	-	5am - 6am	-	-	6am - 7am	-	-	7am - 8am	-	-	8am - 9am	-	-	9am - 10am	-	-	10am - 11am	-	-	<p>Station and Band Coordinators will monitor the SSB/Digital operating positions and ensure that the station sign-up sheet is enforced. They will also monitor who comes in and out to make sure there aren't too many crowds or loud noises to disturb the operators. If there are open spots the coordinator can assign folks who walk in or move operators as needed depending on band conditions. This is a very important role and you should familiarize yourself with the radios used, and general trends in band conditions. You will have help, so do not worry if you are not fully comfortable with all the radios etc. Your main job is to keep the operators going and manage the stations so folks follow the sign-up sheet.</p>	
Time:	Volunteer 1	Volunteer 2																																																																																
Saturday:	-	-																																																																																
1pm - 2pm	K5GN Dave McCarty (SSB)	-																																																																																
2pm - 3pm	-	-																																																																																
3pm - 4pm	-	-																																																																																
4pm - 5pm	K5Yzq version [ssb] dmr.gpms	-																																																																																
5pm - 6pm	-	-																																																																																
6pm - 7pm	-	-																																																																																
7pm - 8pm	-	-																																																																																
8pm - 9pm	-	-																																																																																
9pm - 10pm	-	-																																																																																
10pm - 11pm	-	-																																																																																
11pm - 12am	-	-																																																																																
Sunday:	-	-																																																																																
12am - 1am	K5GN Dave McCarty (SSB)	-																																																																																
1am - 2am	-	-																																																																																
2am - 3am	-	-																																																																																
3am - 4am	-	-																																																																																
4am - 5am	-	-																																																																																
5am - 6am	-	-																																																																																
6am - 7am	-	-																																																																																
7am - 8am	-	-																																																																																
8am - 9am	-	-																																																																																
9am - 10am	-	-																																																																																
10am - 11am	-	-																																																																																





# Volunteer Sign-Up Sheet

## BVARC, TDXS, KARS ARRL Field Day 2023 Volunteer Sign-up sheet

There are MANY MANY important volunteer roles we need filled. Please see the list below with detailed descriptions (scroll down to see all). Type in your call sign (or name if you do not have a call sign) in the spaces open. Please do not sign up for more than three consecutive hours. Most of the positions will be easygoing, but we also want you to take some time enjoy the various activities going on at Field Day AND operate the stations! Meals will be brought to you if you at your assigned location during meal times. If you sign up but are unable to come, please let us know as soon as possible. If you sign up please attend some of the Field Day planning meetings this month. If you have any questions or recommendations about further volunteer positions please contact Kori Rahman WX5KR at Kori113@gmail.com

## Volunteer Frequency Plan

General Volunteer FM Simplex: 147.550 MHz

Crossband repeat (to the 146.940MHz Repeater) 446.4375MHz PL 103.5 Hz

Leads Direct FM Simplex: 446.125MHz

Please program these into your HTs before the event.

### Saturday Information Table, SDR, Info. Screens, and General Help

Time:	Volunteer 1	Volunteer 2	Volunteer 3	Volunteer 4	Volunteer 5
9am - 10am	-	-	-	-	-
10am - 11am	KF5UXP	-	-	-	-
11am - Noon	-	-	-	-	-
Noon - 1pm	-	-	-	-	-
1pm - 2pm	-	-	-	-	-
2pm - 3pm	-	-	-	-	-
3pm - 4pm	KI5WXW	-	-	-	-
4pm - 5pm	KI5WXW	-	-	-	-
5pm - 6pm	KI5WXW	-	-	-	-

Saturday Information Table helpers will be responsible for meeting guests as they come in and getting them signed in and where they need to be. Please fill in the "Volunteer 1" position first, we would like at least a couple of slots filled per hour, but we will take up to 5 per hour if we can get them. There will be flyers to hand out, a computer running a WebSDR station you can show our guests, and the sign-up sheet will be posted on a screen which you will use to direct folks to their stations or add newcomers to the list as they come in. We need lots of folks to take care of this position as we anticipate a large number of the general public and new hams to attend.

[Tinyurl.com/FieldDayVolunteers2023](https://tinyurl.com/FieldDayVolunteers2023)

# Volunteer Sign-Up Sheet

Volunteer Frequency Plan
General Volunteer FM Simplex: 147.550 MHz
Crossband repeat (to the 146.940MHz Repeater) 446.4375MHz PL 103.5 Hz
Leads Direct FM Simplex: 446.125MHz
Please program these into your HTs before the event.

# Volunteer Sign-Up Sheet

## VARRC, TDXS, KARS ARRL Field Day 2023 Volunteer Sign-up sheet

There are MANY MANY important volunteer roles we need filled. Please see the list below with detailed descriptions (scroll down to see all). Type in your call sign (or name). If you do not have a call sign in the spacies open. Please do not sign up for more than three consecutive hours. Most of the positions will be easygoing, but we also want you to have some time to enjoy the vacuue chow going on at Field Day. AND operate the station! Meals will be brought to you if you at your assigned location during meal times. If you sign up but are unable to come, please let us know as soon as possible. If you sign up please attend one of the Field Day planning meetings this month. If you have any questions or recommendations about further volunteer positions please contact Kon Rahman VVXSR at Kon113@gmail.com

## Volunteer Frequency Plan

General Volunteer FM simplex: 147.550 MHz  
Crossband repeat (to the 146.540MHz repeater) 446.471MHz PL 103.5 Hz  
Locals Direct FM simplex: 446.120MHz  
Please program these into your HTs before the event.



Saturday Information Table: SDR, Info, Scores, and General Help				
Time	Volunteer 1	Volunteer 2	Volunteer 3	Volunteer 4
8am - 10am	-	-	-	-
10am - 11am	VF2JUP	-	-	-
11am - Noon	-	-	-	-
Noon - 1pm	-	-	-	-
1pm - 2pm	-	-	-	-
2pm - 3pm	-	-	-	-
3pm - 4pm	K6BKW	-	-	-
4pm - 5pm	K6BKW	-	-	-
5pm - 6pm	K6BKW	-	-	-

Saturday Information Table helpers will be responsible for reading guests as they come in and getting them signed in and where they need to be. Please fill in the "Volunteer 1" position first, we would like at least a couple of slots filled per hour, but we will take up to 5 per hour if we can get them. There will be forms to hand out, a computer running a WebSDR station you can show our guests, and the sign-up sheet will be posted on a screen which you will use to direct folks to their stations or add newcomers to the list as they come in. We need lots of folks to take care of this position as we anticipate a large number of the general public and new hams to attend.

Time		Saturday Antenna Cleaners Help
Noon - 1pm	VF2JUP Chuck Hale	Antenna class helpers will help the instructors set out the materials for the class, help clean up after the class, and generally help the instructor as needed. The current schedule for the antenna build classes are 1pm - 2pm for the dipole build by Mark K6DND, and the EFHW class will be from 2pm - 4pm by Stephen W6WOF. Tuning of the antennas will be done outside after each class in drive building.
2pm - 3pm	-	-
3pm - 4pm	-	-

Time		Station and Band Coordinator
Saturday		Station and Band Coordinators will monitor the SSB/Digital operating positions and ensure that the station sign-up sheet is enforced. They will also monitor who comes in and stand to make sure there aren't too many people at band breaks. To disturb the operators. If there are open spots the coordinator can assign guests to help or more operators as needed. Depending on band conditions. This is a very important role and we need to have people familiar with the radio used and general trends in band conditions. You will have help, so do not worry if you are not fully comfortable with all the radios etc. Your main job is to keep the operators going and manage the stations so folks follow the sign-up sheet.
1pm - 2pm	-	K6DND Dave McCarty (SSB)
2pm - 3pm	-	-
3pm - 4pm	-	-
4pm - 5pm	-	K6BKW version 3000 omni-gms
5pm - 6pm	-	-
6pm - 7pm	-	-
7pm - 8pm	-	-
8pm - 9pm	-	-
9pm - 10pm	-	-
10pm - 11pm	-	-
11pm - 12am	-	-

Time		Station and Band Coordinator
Sunday		-
12am - 1am	-	K6DND Dave McCarty (SSB)
1am - 2am	-	-
2am - 3am	-	-
3am - 4am	-	-
4am - 5am	-	-
5am - 6am	-	-
6am - 7am	-	-
7am - 8am	-	-
8am - 9am	-	-
9am - 10am	-	-
10am - 11am	-	-
11am - Noon	-	-
Noon - 1pm	-	-

Position		Friday Antenna Crew (1pm - 6pm)
#1	-	K6BKW Chuck Hale
#2	-	K6BKW Richard

Antenna crew will help our antenna lead Bill W6WOF (in addition to others he may bring) to get the antennas up and on time. This will be mostly outdoor work to be prepared, plan to take breaks as needed and stay hydrated!

Position		Friday Radio Crew (1pm - 6pm)
#1	-	VF2JUP Chuck Hale
#2	-	K6DND Dave McCarty
#3	-	-

Radio crew will help set up the radios, hand pass filters, amplifiers, power supplies etc. The leads for this will be Jimmy N6UD and/or Allen N6AZ.

Position		Friday Computer Crew (1pm - 6pm)
#1	-	-
#2	-	-
#3	-	-

Computer crew will assist the computer lead (Dean W6BTF) to set up the computers (plug in power, monitors, keyboards etc.) and make sure each computer is connected to their radios and on the WFF.

Position		Sunday Breakdown/Cleanup (1pm - 4pm)
#1	-	VF2JUP Jack Frost
#2	-	VF2JUP Chuck Hale
#3	-	K6DND Dave McCarty
#4	-	K6BKW Richard
#5	-	-

THIS IS ESSENTIAL! We need to make sure we have folks who will be there for us once all of the crews and the fun is over as we can disconnect equipment, roll up cables, clean up the area, return all pieces of their original configurations and leave the place spotless. Please sign-up if you can as we can have a successful and stress-free ending to this great event.

Time		Saturday Talk-in Net Controller
8am - 10am	-	-
10am - 11am	-	-
11am - Noon	-	-
Noon - 1pm	-	-
1pm - 2pm	-	-
2pm - 3pm	-	-
3pm - 4pm	-	-
4pm - 5pm	-	-
5pm - 6pm	-	-

All net controllers must have an FCC Amateur License and preferably some experience running a radio net. This job will be simple but important. You will periodically encourage the talk-in net (and the event in general) over the 146.540MHz repeater. The talk-in net controller will take any incoming requests for directions or other questions by folks coming in, or from off-site helpers. Since we will have crossband repeat going, this role does not have to be stationary and you can walk around with your HT and headset. BUT you MUST monitor and respond to calls on the repeater during your assigned slot.

Time		General Help After 6pm Sat - 1pm Sun
Saturday		-
8pm - 7pm	-	K6BKW
7pm - 6pm	-	-
6pm - 5pm	-	-
5pm - 4pm	-	-
4pm - 3pm	-	-
3pm - 2pm	-	-
2pm - 1pm	-	-
1pm - 12am	-	-
Sunday		-
12am - 1am	-	-
1am - 2am	-	-
2am - 3am	-	-
3am - 4am	-	-
4am - 5am	-	-
5am - 6am	-	-
6am - 7am	-	-
7am - 8am	-	-
8am - 9am	-	-
9am - 10am	-	-

This is for general help after the information table shuts down and most of the crew is sleeping or off-site. These helpers will keep an eye on things, add fuel to the generators, monitor folks into the site, and help out with any logistics or issues that may arise.

# Bonus Point Prospects

Bonus Point	Points	Multiplier	Total Bonus
100% Emergency Power	100	10	1000
Media Publicity	100	0	0
Set up in Public Place	100	1	100
Public Information Table	100	1	100
Message to ARRL Section Manager	100	1	100
W1AW Message	100	1	100
Message Handling NTS Traffic 10x	10	10	100
Satellite QSO	100	1	100
Alternate Power (Solar+Battery) 5 QSOs	100	1	100
Visit by elected Official	100	1	100
Visit by served Agency Official	100	1	100
Educational Activity	100	1	100
Youth Participation (1 contact x 5 under 18)	20	5	100
GOTA Station (Review Criteria)	?	?	100+
Web Entry	50	1	50
Safety Officer	100	1	100
Social Media Bonus	100	1	100
<b>Total Bonus Points</b>			<b>2250</b>

One last thing...

**???**



# Field Day Raffle

**There will be a raffle!**

Tickets will only be sold on site at Field Day

Raffle Items will include:

- 2m/70cm BaoFeng HT
- Ham books
- **QRP 5-band Transceiver (CW,LSB,USB,AM,FM)**
- More to come
- Please donate to the raffle!



# Promote Field Day 2023!

- Post about the event on social media!
- Put up our “For the Public” flyers!
- Talk about the event on the air!
- Carrier pigeon!



# More planning meetings to come!

Planning Meetings on Zoom every Wednesday at 6pm

- June 14th and June 21st

Field Day Planning Meeting in-person

- Saturday June 17th at 1pm at the Fire Training Field  
260 Clay St  
Richmond, TX 77468

# BVARC.ORG & Reflector for updates





# Questions?